



型号: B0520LW/B0530W/B0540W

肖特基二极管 SCHOTTKY DIODE

主要特性/Features

正向电压降低 Low Forward Voltage Drop

暂态保护的保护环结构 Guard Ring Construction for Transient Protection

高导电 High Conductance

应用/Application

暂无

印字/MARKING

等效电路/Equivalent Circuit

型号	B0520LW	B0530W	B0540W
印章	SD	SE	SF

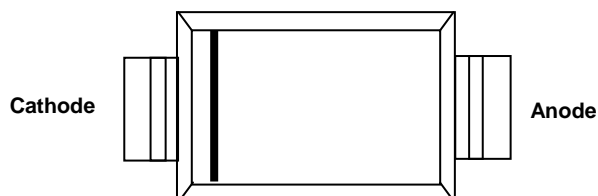



极限参数/Absolute maximum ratings(Ta=25°C)

Parameter	Symbol	B0520LW	B0530W	B0540W	Unit
Peak Repetitive Reverse Voltage	V_{RRM}				
Working Peak Reverse Voltage	V_{RWM}	20	30	40	V
DC Blocking Voltage	V_R				
RMS Reverse Voltage	$V_{R(RMS)}$	14	20	28	V
Average Rectified Output Current	I_o	500			mA
Forward Surge Current Peak	I_{FSM}	5.5			A
Power Dissipation	P_d	500			mW
Thermal Resistance Junction To Ambient	$R_{\theta JA}$	200			°C /mW
Junction Temperature	T_j	125			°C
Storage Temperature	T_{stg}	-55 ~ 150			°C
Voltage rate of Change	dv/dt	1000			V/μ S

电性能参数/Electrical characteristics (Ta=25°C)

Parameter	Symbol	Test condition	B0520LW	B0530W	B0540W	Unit
Minimum Reverse Breakdown Voltage	V(BR)R	$I_R=250\mu A$	20			V
		$I_R=200\mu A$		30		
		$I_R=20\mu A$			40	
Forward Voltage	VF1	IF=0.1A	0.32	0.375	--	V
	VF2	IF=0.5A	0.385	0.43	0.51	V
	VF3	IF=1A	--	--	0.62	V
Reverse Current	IR1	VR=10V	75	--	--	μ A
	IR2	VR=15V	--	20	--	
Reverse Current	IR3	VR=20V	250	--	10	μ A
	IR4	VR=30V	--	130	--	
	IR5	VR=40V	--	--	20	
Capacitance Between Terminals	CT	VR=0V,f=1.0MHz			170	pF



典型特性曲线图/Typical Characteristics

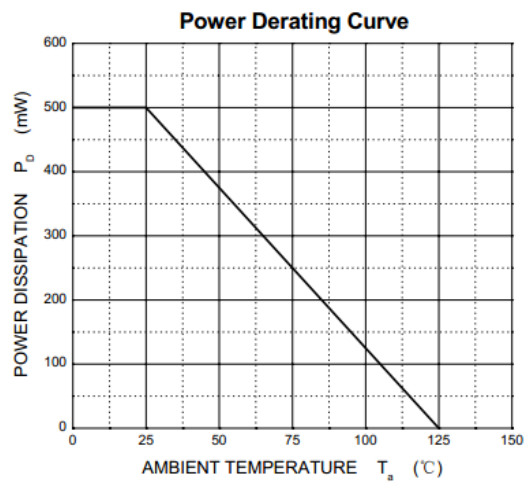
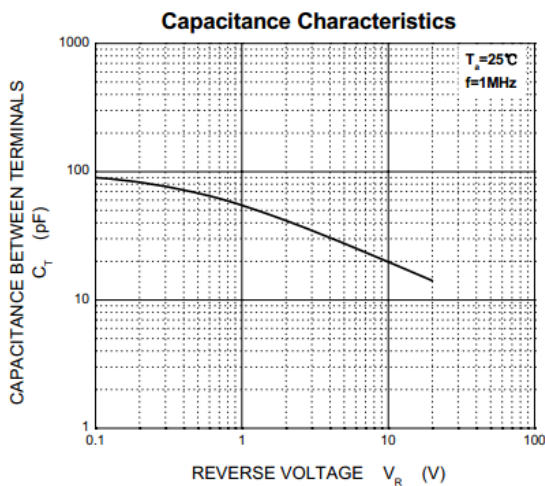
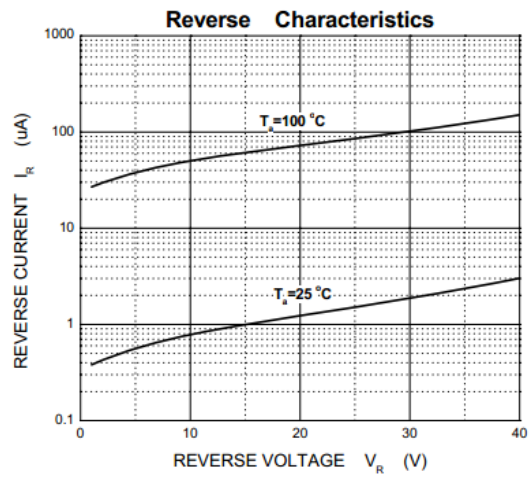
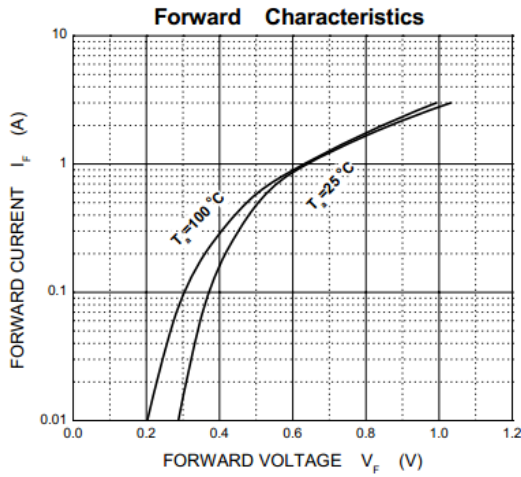



成品外观尺寸/SOD-123 Package Information

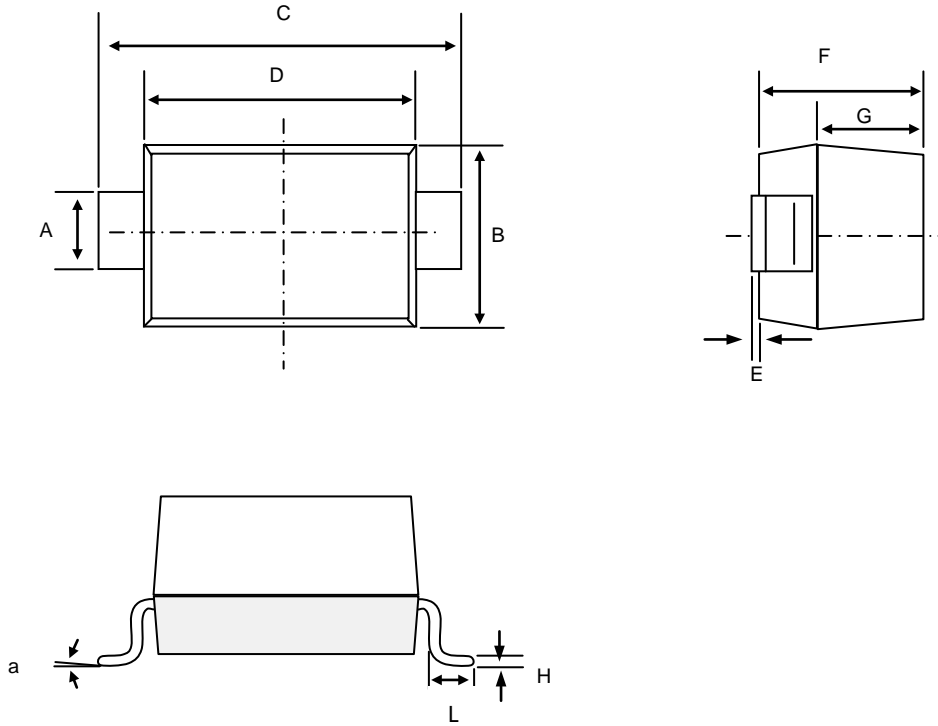

Symbol	Dim in mm		
	Min	Nor	Max
A	0.520	0.550	0.570
B	1.400	1.550	1.700
C	3.350	3.650	3.850
D	2.550	2.650	2.850
E	0.000	0.050	0.100
F	1.050	1.100	1.150
G	0.620	0.650	0.670
H	0.100	0.110	0.120
L	0.250	0.350	0.450
a	0°	-	6°